

24HR / 70GL FUEL TANK

JD30-03IT4

PD20-01IT4

LV0 / LV1 / LV2 / LV3

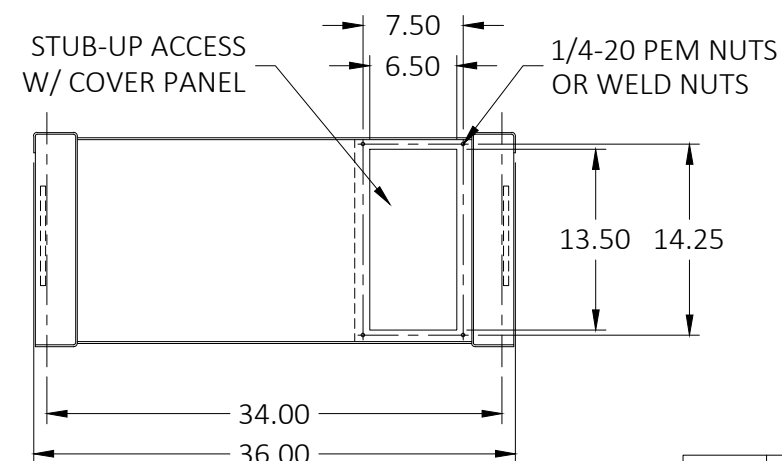
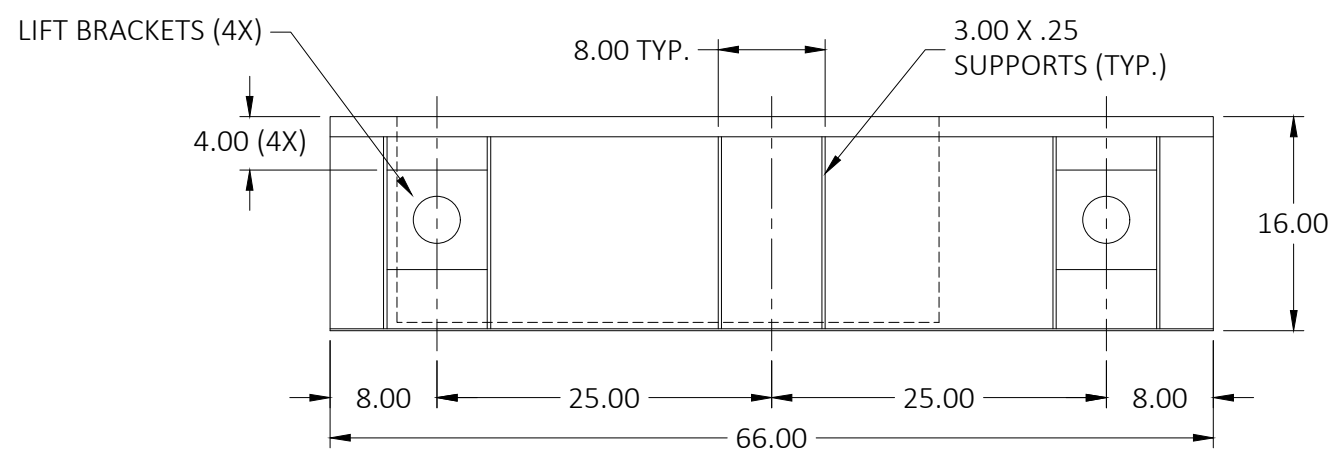
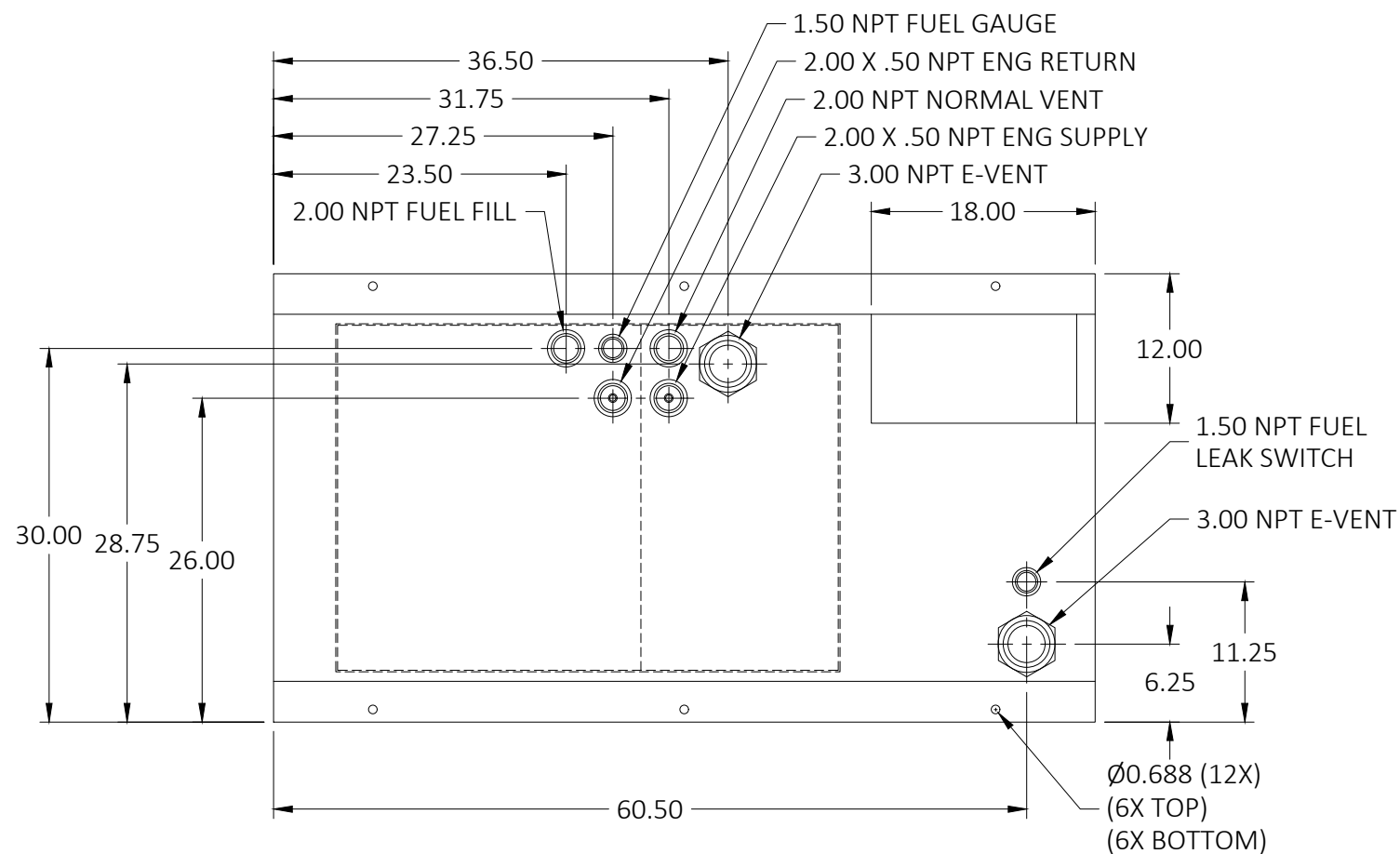

NOTES:

1. MATERIAL: PER UL/ULC REQUIREMENTS
2. SECONDARY CONTAINMENT TANK
3. TANK TO INCLUDE:
  - FUEL SUPPLY/RETURN DIP TUBES
  - LIFTING/TIE DOWN BRACKETS

MATERIAL: SEE NOTES

FINISH: BLACK HAMMERED

REMOVE ALL BURRS AND SHARP EDGES  
 TOLERANCE UNLESS OTHER SPECIFIED:  
 FRACTIONAL: ± 1/32  
 ANGULAR: ± 1°  
 X.X = ± .1  
 X.XX = ± .03  
 X.XXX = ± .010

R06	SHORTENED STUB-UP ACCESS	04-09-21	CRC
LEVEL:	DESCRIPTION:	DATE:	BY:
REVISIONS:			
<small>THE INFORMATION CONTAINED IN THIS DRAWING IS THE SOLE PROPERTY OF BLUE STAR POWER SYSTEMS, INC. ANY REPRODUCTION, IN PART OR AS A WHOLE, WITHOUT THE WRITTEN PERMISSION IS PROHIBITED.</small>			
<small>2250 CARLSON DRIVE, NORTH MANKATO, MINNESOTA 56003   1 507 345 1776</small>			
<b>TANK SB 70GL DW SC UL/ULC W/ STUB-UP</b>			
	NAME	DATE	SIZE PART NUMBER:
	DRAWN BY: CRC	11-17-22	<b>B</b> 20042
DO NOT SCALE DRAWING	APPROVED: CRC	11-17-22	SCALE: NONE APPROX. WEIGHT: 550 LBS SHEET 1 OF 1