

24HR TANK VD550, VD600 (FT4) LV0/LV1/LV2/LV3

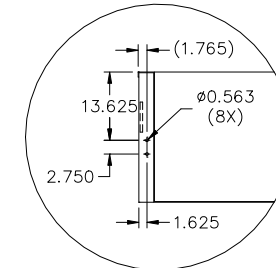

STEP HOLE DETAIL

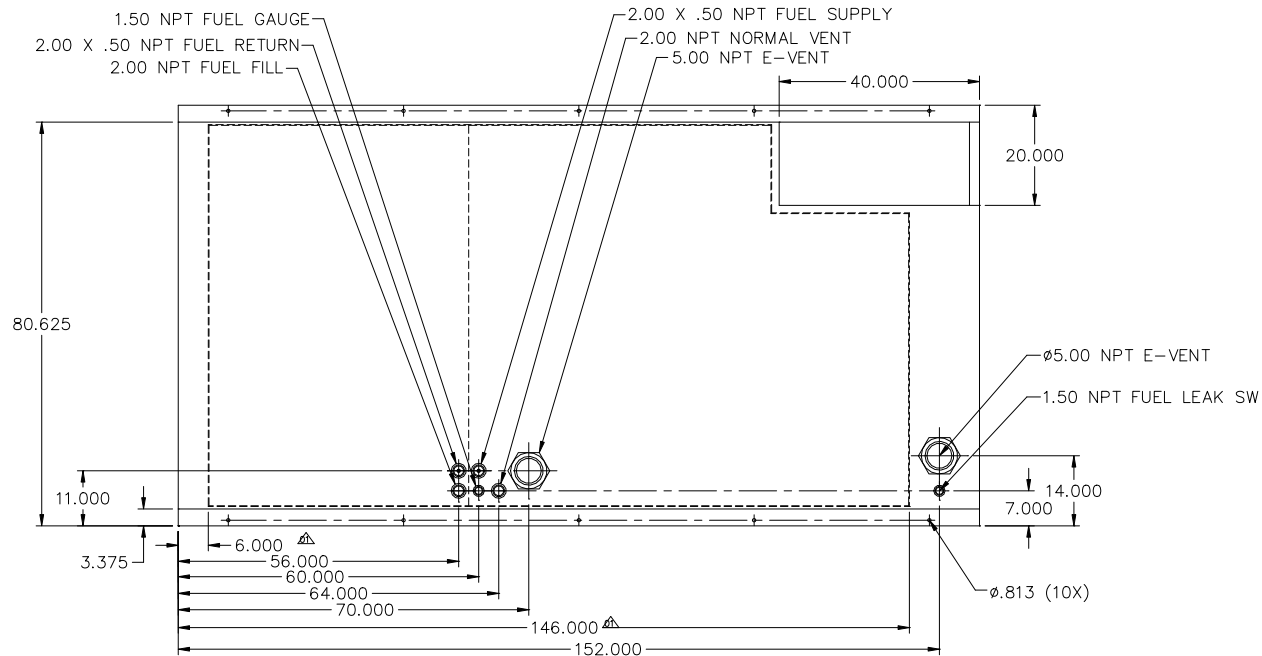
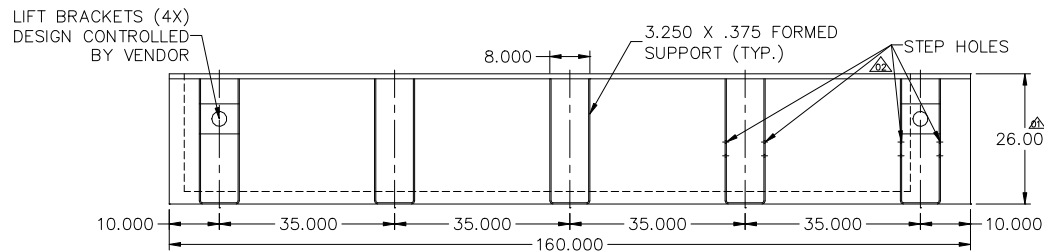

LIFT BRACKETS (4X)
DESIGN CONTROLLED
BY VENDOR

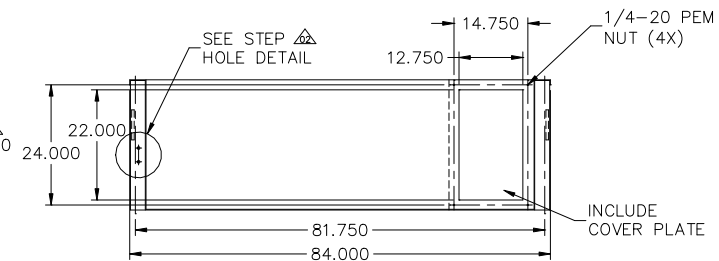

NOTES:

1. MATERIAL: 10GA. INNER TANK BASIN
7GA. RUPTURE BASIN
2. SECONDARY CONTAINMENT TANK
3. FINISH PAINT GLOSS BLACK
4. TANK TO INCLUDE
 - FUEL SUPPLY / RETURN DIP TUBES
 - LIFTING / TIE DOWN BRACKETS

APPROXIMATE WEIGHT: 4,000 LBS

REVISIONS:

LEVEL:	DESCRIPTION:	DATE:	BY:
02	ADDED STEP HOLES	12-19-16	KDH
01	MATERIAL CHANGE 7 / 7 TO 10 / 7, INCREASE HEIGHT 2.00"	10-26-16	KAP

BLUE STAR

Power Systems Inc.

TANK SB 1000GL DW UL W/STUB-UP

P/N: 20559 160"L X 84"W X 26"H

DATE: 12-22-15

BY: KDH

DRAWN TO SCALE